

Installation Guide for Rubber Compensator's

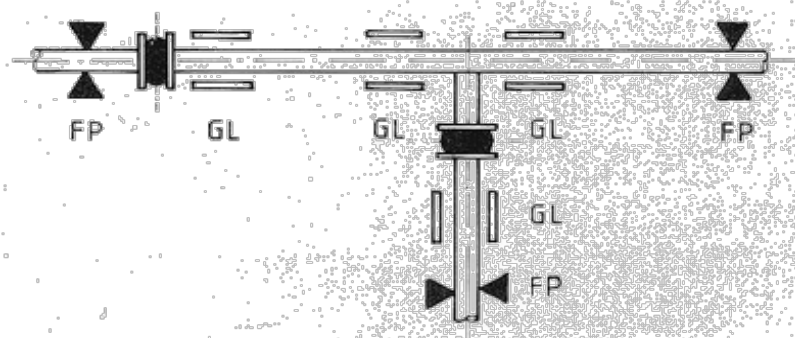
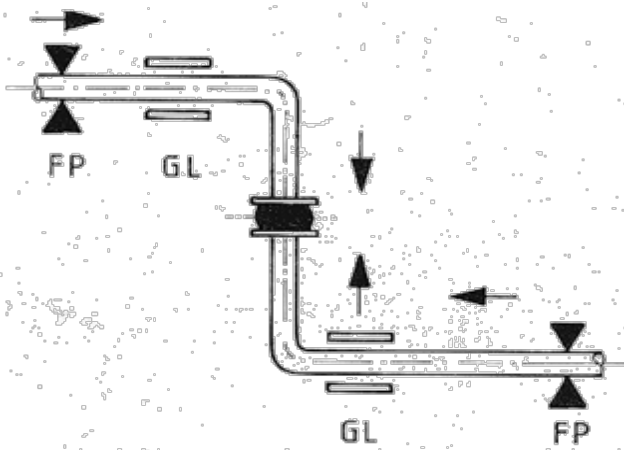
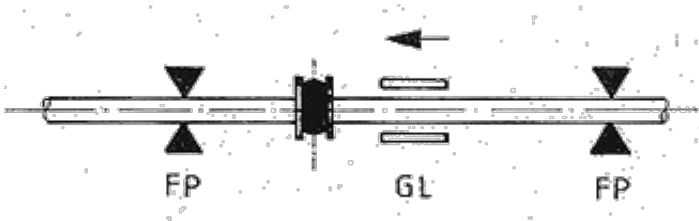

1. Structure

DONGYANG S&T compensators are delivered ready for installation.

The surface of the swivel flanges to DIN,ISO,JIS... etc. should be smooth and clean and fit easily on the compensator,so that approx. 3mm of rubber sealing profile protrudes.

When mounting onto the conduit(flange with seal or plain coupling) no additional gaskets are required.

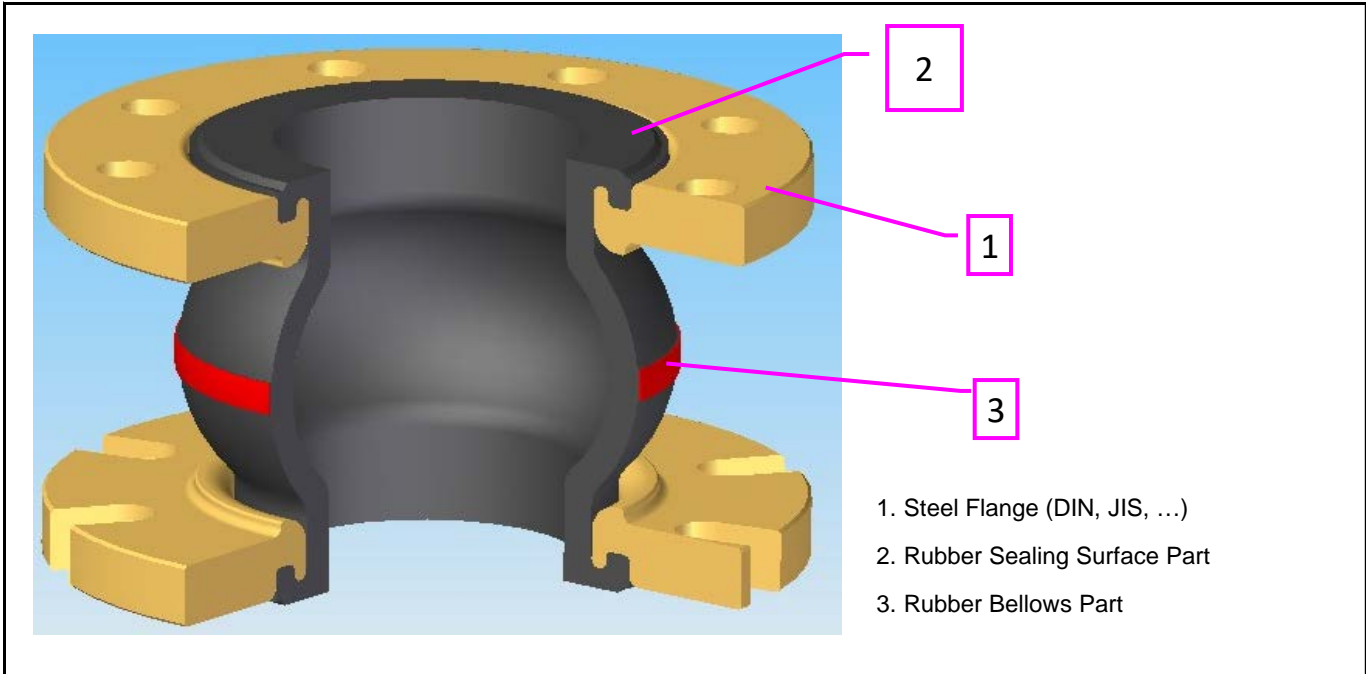

※ Attention!

The compensator sealing surface must fit closely over the whole width of mating flange.

For enlarged inner diameter pipe(e.g. slip-on flange DIN 86029) or edge flanges(e.g. DIN 2642) the sealing surface must be further reduced by use of an additional ring(at least 5mm thick!)down to the specified dimension NB.

■ Marking

Marking : DYV-W Type DY 100 4in  16

Type Designation

Size(mm/inch)

Manufacture date

Max. Pressure

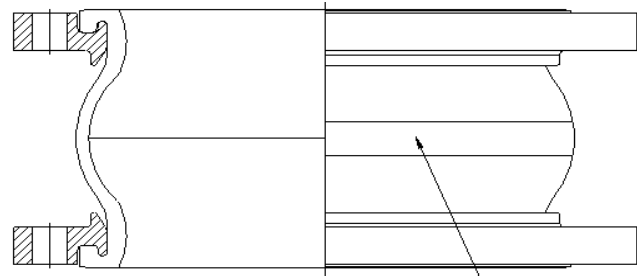

Bellows Color Band Marking

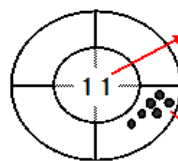

Marking	10	11	12	13	14	15
Year	2010	2011	2012	2013	2014	2015

Marking	●	●●	●●●	●●●●	-----	-----
Month	Jan.	Feb.	Mar	Apr	-----	-----

2. Mounting

1. Prior to the installation of the expansion joint ensure that the mating flanges have satisfactory sealing surfaces. Protruding pipe ends, grooves and tongues are not permitted as the sealing surface of the bellows might be destroyed.

Attention : When using slip-on flanges the outside diameter must be larger than the sealing surface of the expansion joint.

- 2) Pay attention to the correct installation length : The pulling of expansion joints into installation gaps which are too large will lengthen the rubber bellow and might 'lead to the collar being drawn out of the flange groove see picture. During the subsequent tightening of the screws the collar of the bellows would be crushed asymmetrically.

Please note:A considerable lengthening during installation decreases the allowable range of movement during operation. To shorten installation gaps, distance flanges are available.

- 3) If possible, the expansion joints, should be installed in such a way that the date of production is visible.
- 4) Screws should be inserted from the expansion joint side. If this is not feasible, it must be assured that the bellows may not touch the screws in all operating conditions.
- 5) We recommend to use bolts of property class 8.8.

Bolt Assemble Steps.

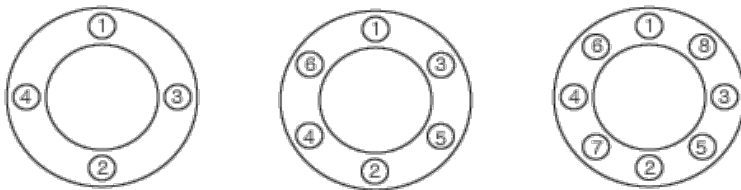

1st step:Tighten bolts equally by hand (pay attention to parallel sealing surfaces!).

2nd step:Fixed to the cross shape.

3rd step:Be Firmly fixed.(Min. 130 Nm)

Do not use any sharp-edged tools which might damage the rubber bellow in case the tool slips

- 6) The rubber bellow of the expansion joint must not be painted! Solvents can damage the rubber cover, furthermore the colour coat impedes a proper visual inspection.

- 7) When welding and cutting, the rubber bellow is must be protected against heat by all means.

For electric welding it must be insured that the electric current does not pass through the bellows.

8) Permanent radiation heat above 90° C must be avoided.

In case of need flame protection covers should be used

9) Rubber expansion joints are subject to wear and must be included in the routine inspection of the pipe system (visual inspection of the expansion joint regarding damages as well as inspection for induration by pushing in with a thumb).

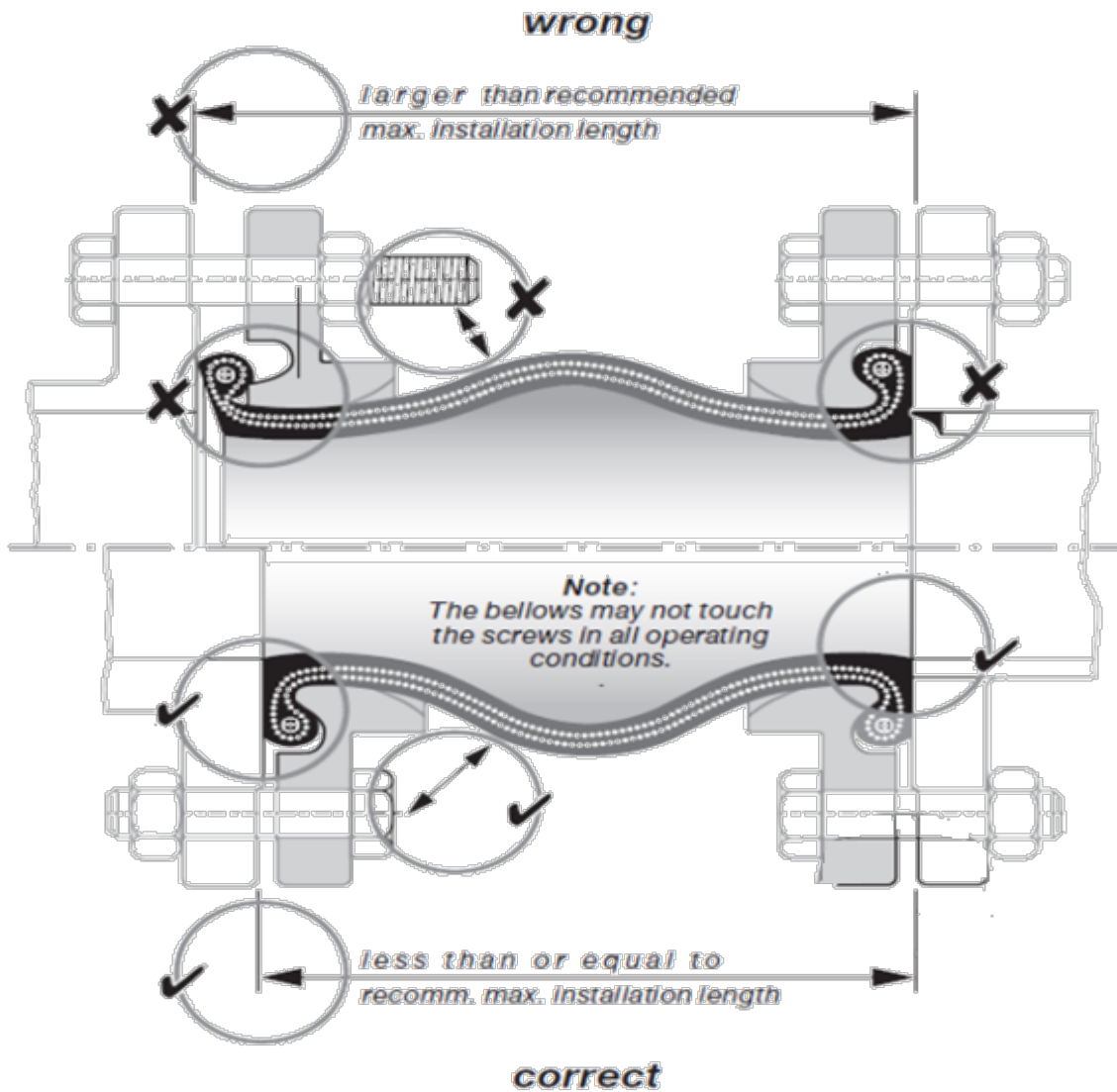

■ Installation and Operation Hints for Rubber Compensator's

